

**Product Details**

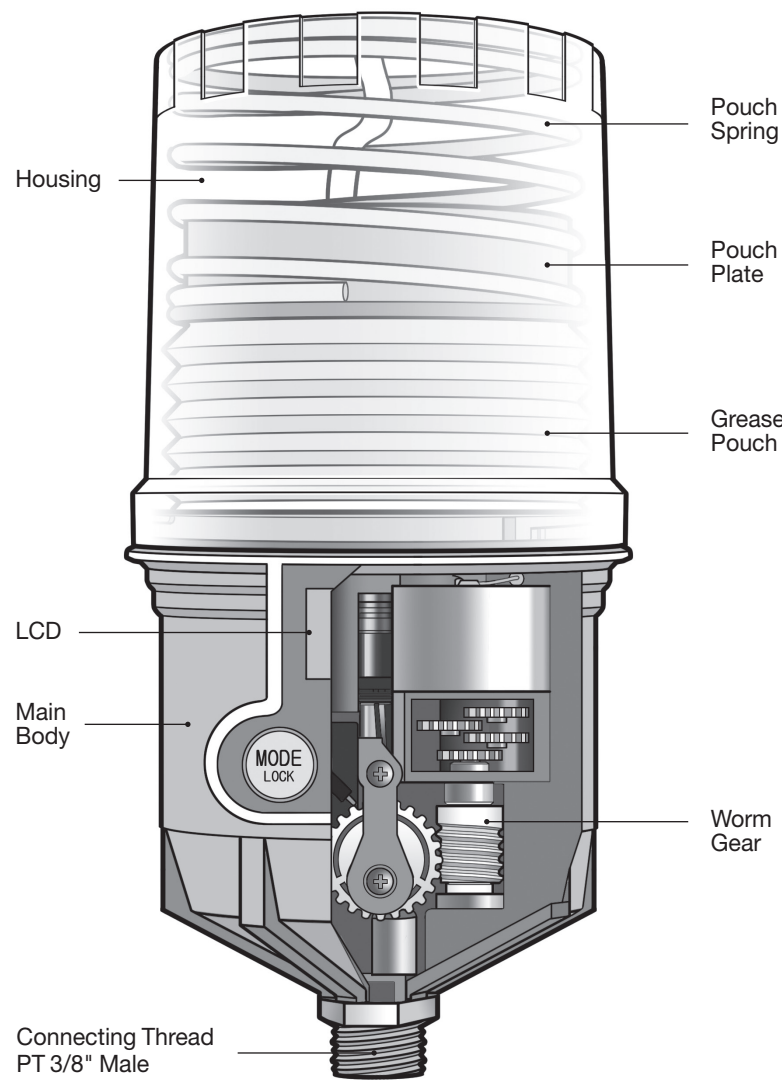

**Installation Guidelines**

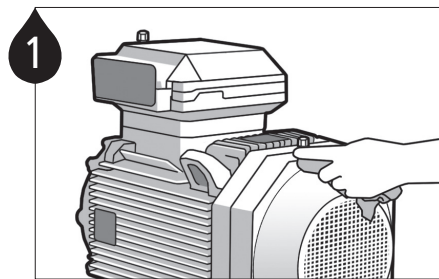

1 Remove contaminants around the lube point.

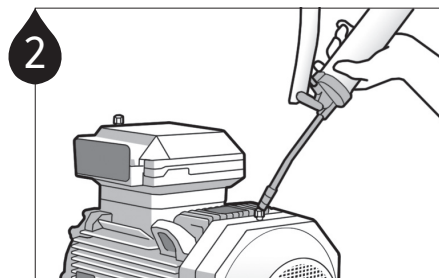

2 Ensure a clear passage using a manual grease gun. **Note1** Remove any hardened grease by purging the lube point with a manual grease gun. **Note2** The grease in the equipment and the grease contained in the unit should be the same or compatible.

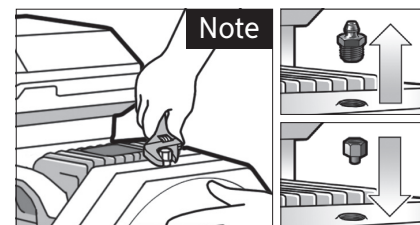

5 Remove the grease nipple and install appropriate adaptors.



3 Check the grease pouch capacity and the service pack items (battery pack, grease pouch & dust cover).

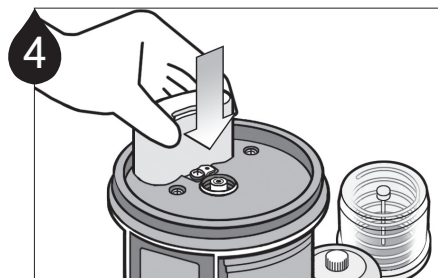

4 Insert a new battery pack.



5 Purge the grease pouch until grease comes out of the tip.

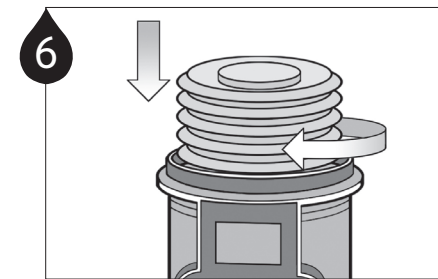

6 Carefully screw the grease pouch in by turning clockwise. Do not over tighten.

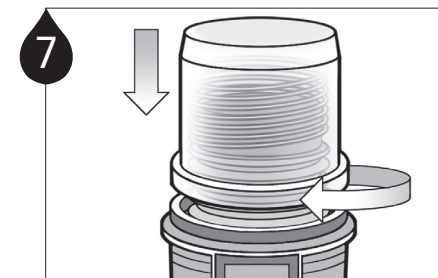

7 Refit the top housing on the unit and turn clockwise until it clicks.

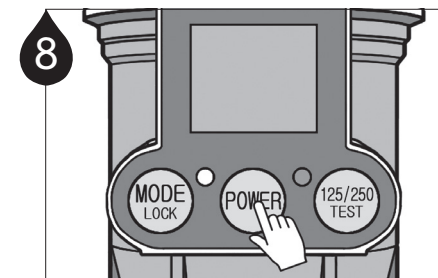

8 Press the POWER button for 2 seconds to turn the unit on.

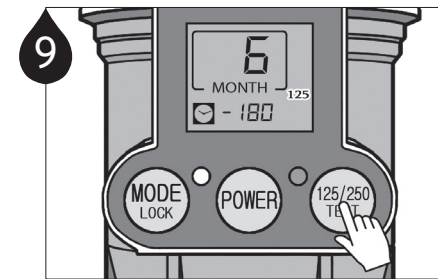

9 Select the appropriate grease pouch capacity by pressing the 125/250/TEST button.

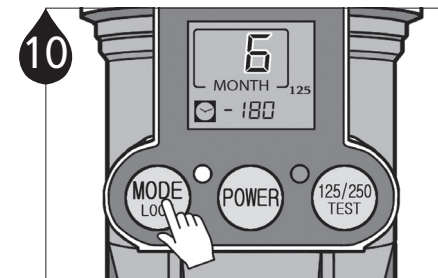

10 Press the MODE button to program the dispensing period.

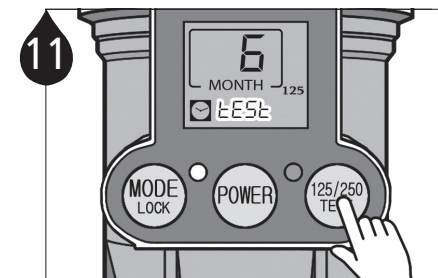

11 Press the TEST button for 2 seconds to run a test cycle and check for proper operation of the unit.

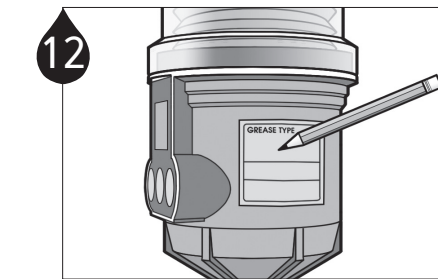

12 Note the installation date and the scheduled completion date of lube cycle on the lubricator using the label provided in the Service Pack for maintenance purposes.

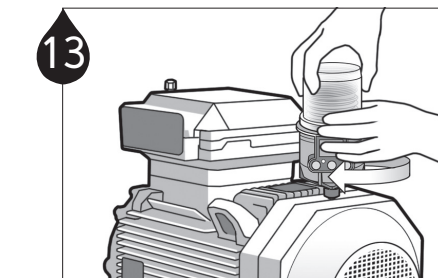

13 Install the Pulsarlube EX unit on the lube point. When the selected dispensing period has completed, replace the unit with the Service Pack according to step #3-7.

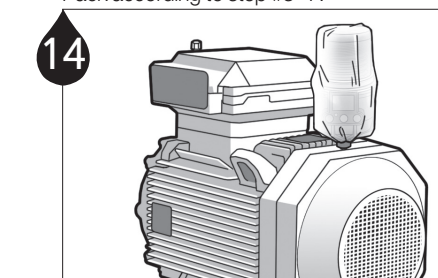

14 Install the dust cover over the lubricator for added protection.

**Troubleshooting Guidelines**

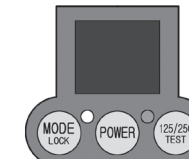

**Symptom** : Blank LCD screen  
**Possible Cause** : Electrical malfunction of CPU or circuitry, battery problem  
**Solution** : Replace battery pack or press reset button to restart the lubricator. If the problem persists, contact your supplier.

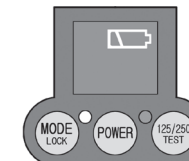

**Symptom** : Low Battery Indication  
**Possible Cause** : Rapid power consumption due to improper storage or harsh operating conditions (temperature, humidity, or high backpressure).  
**Solution** : Store the battery pack in cool, dry place and choose proper battery type for application. Optional lithium battery pack is available for more advanced applications.

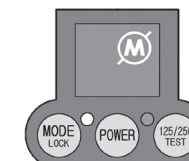

**Symptom** : Excessive Backpressure Indication  
**Possible Cause** : Excessive backpressure due to hardened grease, over-lubrication, ruptured lube line, long distance remote installation, etc.  
**Solution** : A) Check backpressure at lube point and/or lube line, B) check grease dispensing rate, C) reduce remote installation distance, or D) use manual grease gun to clear blockage.

## Button Operation

### MODE LOCK

#### Dispensing Period

Press to set dispensing period  
1, 2, 3, 6, 12 month & 15 days (H)

Automatic Lock Out Mode

Press for 2 seconds to unlock (🔒)

### POWER

Power **ON/OFF**

Press to Power unit On or Off

### 125/250 TEST

#### Grease Capacity

Press to select 125ml/250ml

\*Only available in EX250

#### TEST Mode

ON : Press for 2 seconds

OFF : Short press of button

(will stop after completion of ongoing cycle)

## LCD Display



Dispensing period setting

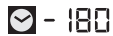

Remaining dispensing days



Automatic Lock Out mode



Grease pouch capacity



TEST mode



Number of days since the cycle ended (🔒 and 📅 will also display)

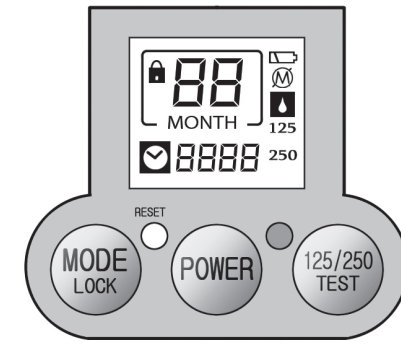

### RESET

Reset to default setting when the unit malfunctions and/or after changing the Service Pack



Number of days operation has been on hold due to excessive backpressure



Low battery power



Operation on hold due to excessive backpressure



Empty grease level



LED blinks when battery is low, excessive backpressure exists, or grease level is empty

ISO9001/14001 CE

## Product Certifications



EEEx nL IIB T5



Ex nL IIB T5 IP54  
12-KB2BO-0279X



US 6.354.816  
6.498.956  
EP1 104 867

The Pulsarlube EX is tested and certified by ATEX (Europe), and KCs (Korea).

## Mounting Methods

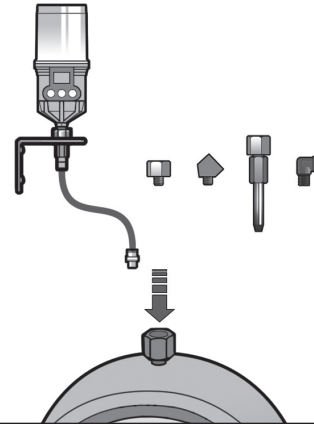

### Single Point Installation

Direct Mount or Remote Installation using Extension Tube

Direct mount is always preferable. For applications not allowing any direct mounts, remotely mount the unit using appropriate accessories and keep the distance from the lube point as short as possible.

For remote installation using a tube, use a Ø6 O.D. (1/4") tubing pre-filled with the same or compatible grease as the grease contained in the unit.

## Warning

**Explosion Hazard - Do not remove or replace batteries unless power has been disconnected or the area is known to be free of ignitable concentrations of flammable gases or vapors.**

▶ Replace Battery With Pulsarlube EX's battery pack only. Use of Another Battery May Present A risk of Fire or Explosion. See Owner's Manual For Safety Instructions.

Reference Designation	Description	Type of Protection
M1	Motor	Non-incendive Circuit
SW4	Reed Switch	Non-incendive Circuit

**Shelf life and Product Warranty** Warranty is limited to original defects in material and workmanship and will not cover any collateral damage due to mishandling, abuse and /or any other inappropriate use of this product. Warranty period is 1 year from the date of purchase.

Rev.03

**PULSARLUBE**  
The World Leader of Automatic Lubrication

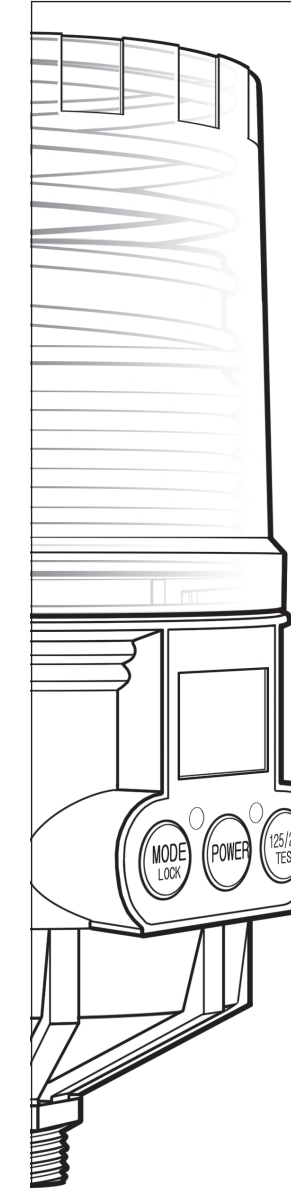

**PULSARLUBE**

User Manual

Pulsarlube **EX**  
**Series**  
(125 & 250ml)

### Pulsarlube USA, Inc.

1480 Howard Street, Elk Grove Village, IL 60007, USA

TEL:1-847-593-5300 FAX:1-847-593-5303 www.pulsarlube.com/info@pulsarlube.com