

Troubleshooting

1. Guidelines



5r00 (Sensor)

Error : Operation on hold due to non-detection of motor sensor
Possible Cause : Problem with the motor sensor
Solution : Contact your supplier



Ch00 (Check)

Error : Motor not responding
Possible Cause : Electric motor may not be able to activate due to possible electrical problem
Solution : Contact your supplier



bP00 (BPSM) * Back Pressure Sensing Mode

Error : Excessive backpressure indication
Possible Cause : Hardened grease obstructing lube point or kinked lube line
Solution : Purge grease into the lube point using a clean manual grease gun to eliminate possible hardened grease that may be causing an obstruction. This will alleviate excessive backpressure. Reduce lube line length if possible.



Error : Blank LCD screen
Possible Cause : MCU electrical malfunction or battery problem
Solution : Replace battery pack / Press reset button to restart the lubricator / Contact your supplier if problem persists

How to order

Grease Code	Application	Product Number
PL1	Multi-Purpose	
PL2	Heavy Duty	
PL3	High Speed	
PL4	H1 Food Grade	
PL5	High Temperature	
PL6	Multi Purpose with MoS2	
PL7	Low Temperature	
PL10	Motor Bearing	

- The warranty period for the battery pack is one year from the date of purchase. Service packs without a battery pack are excluded.
- The warranty is limited to defects in the battery pack itself and does not cover any incidental damage resulting from user mishandling or improper use.

Pulsarlube USA, Inc.

1170 Ardmore Ave Itasca IL 60143, USA

TEL : 1-847-593-5300 | FAX : 1-847-593-5303 | www.pulsarlube.com / info@pulsarlube.com

ISO9001/14001



Rev.02

Pulsarlube Grease Service Pack

USER MANUAL

GREASE TYPE

General Information

1. Product Description



1 Grease pouch

2 Battery pack

3 Dust cover

4 Memo label

- Select a grease pouch capacity (60, 125, 250, or 500ml) according to the specifications of the automatic grease lubricator.
- The standard specification includes an alkaline battery pack. A lithium battery pack can be selected depending on usage conditions.
- Use the dust cover for extra protection against contaminants and water.
- For areas where discoloration from UV exposure may be a concern, a UV dust cover is available separately.
- Indicate the replacement and completion date on the label for easy maintenance.

2. Product Components by Lubricator Model

Category	Components
MSP	1 Grease pouch 3 Dust cover
PLC	1 Grease pouch
Others	1 Grease pouch 2 Battery pack 3 Dust cover 4 Memo label

3. Service Pack Replacement Product Classification

Grease Pouch Capacity	Product line
60ml	Pulsarlube M, MSP, MSP(r), Mi
125ml	Pulsarlube M, MSP, MSP(r), Mi
250ml	Pulsarlube M, MSP, MSP(r), Mi
500ml	Pulsarlube M, MSP, MSP(r)

- To ensure the safe operation and proper installation of the Service Pack, we strongly recommend that you read the following information carefully before use.
- If you require further information, please contact your local supplier or manufacturer.
- Technical information is subject to change without notice.

How to Install and Use

Grease Service Pack Replacement Method

When the dispensing period is complete and it is time to replace the service pack, the red LED will start to blink and the LCD will display the low battery icon, grease drop icon, and the elapsed time (number of days) since the dispensing period has ended.

*All Parts should be assembled tightly with PTFE tape.

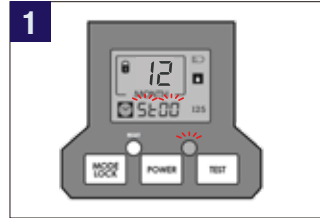

If the LCD displays the icons shown above, it is time to replace the service pack.

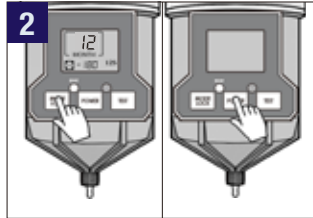

Hold the MODE button until the padlock icon disappears to unlock the unit and then hold POWER until the unit powers off.



Disassemble the housing from the main body.

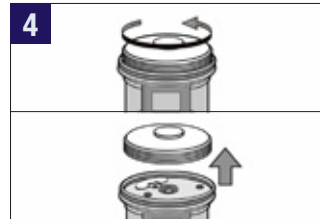

Remove pouch by unscrewing counter-clockwise.
*Take care to prevent dust and other contaminants from getting near the pump while disassembled.

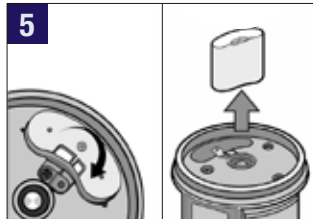

Push down on the battery pack and rotate the clip to the right. Remove the battery pack.

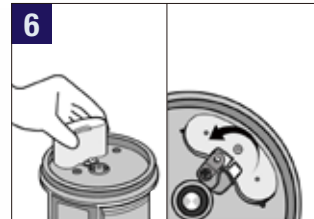

Insert the new battery pack and rotate the clip to the left to secure it.



Unscrew the cap from the new grease pouch and purge out a small amount of grease so that the grease is past the tip of the pouch.

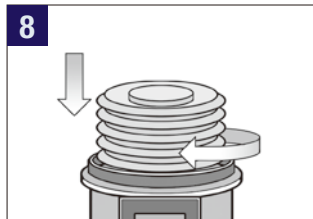

Install the new grease pouch, making sure it is straight vertically and not getting cross-threaded. Install snug and do not over-tighten.

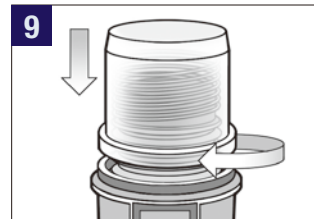

Reinstall the housing.

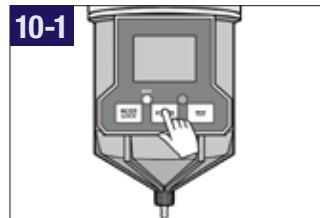

To keep existing settings: Press and hold the power button for 3 seconds. (Automatically sets to the previously configured setting)

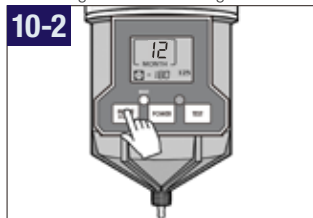

To change the dispensing period setting: Hold the MODE button until the padlock icon disappears to unlock and then press the MODE button again to cycle through the settings.

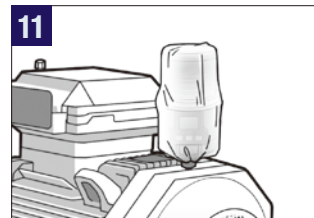

Attach the provided dust cover.



- OEM battery packs and grease pouches must be used when replacing service packs.
- Do not modify or disassemble the battery pack, lubricator, or grease pouch. Doing so may result in dispenser malfunction or compromise the safety of the device.

Additional Information

1. Buttons and LCD Display

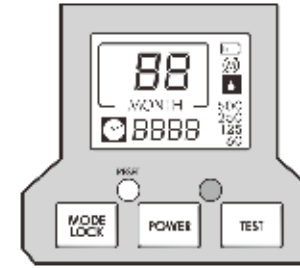

Backlight ON/OFF
Hold the Mode button and then press the Test button



Reset to default setting when the unit malfunctions and/or after changing the Service Pack



Purge Mode

ON : Press for 2 seconds
OFF : Short press of button
(will stop after completion of ongoing cycle)



Dispensing Period

1 ~ 12 month
Automatic Lock Out Mode
Press for 2 seconds to unlock(🔒)



Power ON/OFF
Press for 2 seconds to power unit on or off

	Dispensing period setting		Automatic Lock Out mode		Number of days operation has been on hold due to motor sensor error
	Remaining dispensing days		Operation of the lubricator has been interrupted(refer to Troubleshooting Guideline)		Number of days operation has been on hold due to motor error
	Low battery power		Dispensing period has completed		Number of days since dispensing period has completed (🔒 and 🟡 will also display)
	LED blinks during normal operation		Grease pouch capacity		Number of days operation has been on hold due to backpressure
	LED blinks when battery is low, excessive backpressure exists, or dispensing period has completed				Number of remaining purge cycles

2. Battery Selection

The standard alkaline battery can be used for most installations in satisfactory environments.

The demanding situations below may require a lithium battery.

*🟡: Recommended

	Subject	Description	Alkaline Battery Pack (Standard)	Lithium Battery Pack (Optional)
Application	Direct Mount	-	○	○
	Multi-Point Installation	-	○	🟡
Environment	Pouch Capacity	480ml/500ml	○	🟡
	Temperature Range	-15°C ~ 60°C (5°F ~ 140°F)	○	○
		-40°C ~ -15°C (-40°F ~ 5°F)	×	○

*Single/Multi-Point remote installation lengths varies by product. Please refer to the product detail pages for specifications.